

# camera system

standard resolution and Full-HD

setup display (4,3")  
battery pack or  
shielded power supply  
(standard 230V, 110V  
available too)  
for wall mount application

dAV- camera SD, HD,  
mini-HD or μ

pan-/tilt unit\*  
(optional)

PT-02: wall / ceiling mount  
PT-03: mobile use on monopod or tripod

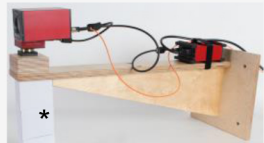

wall mount WCM40  
optional TRX  
platform



mk monopod  
optional ball casters

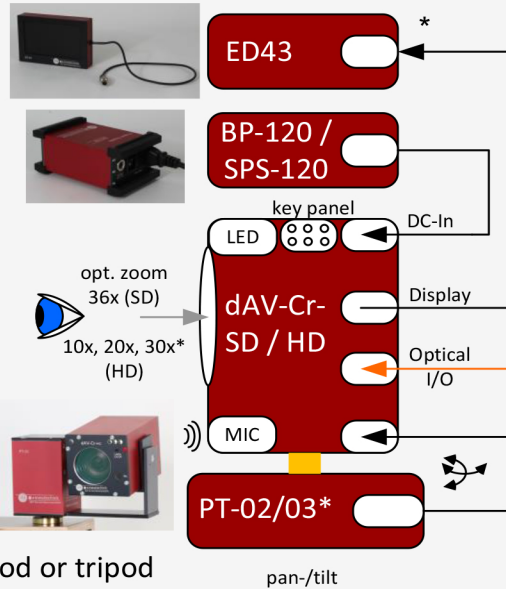

video, audio  
and remote  
over one  
fiber

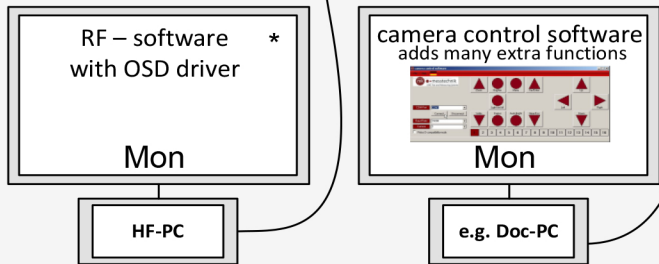
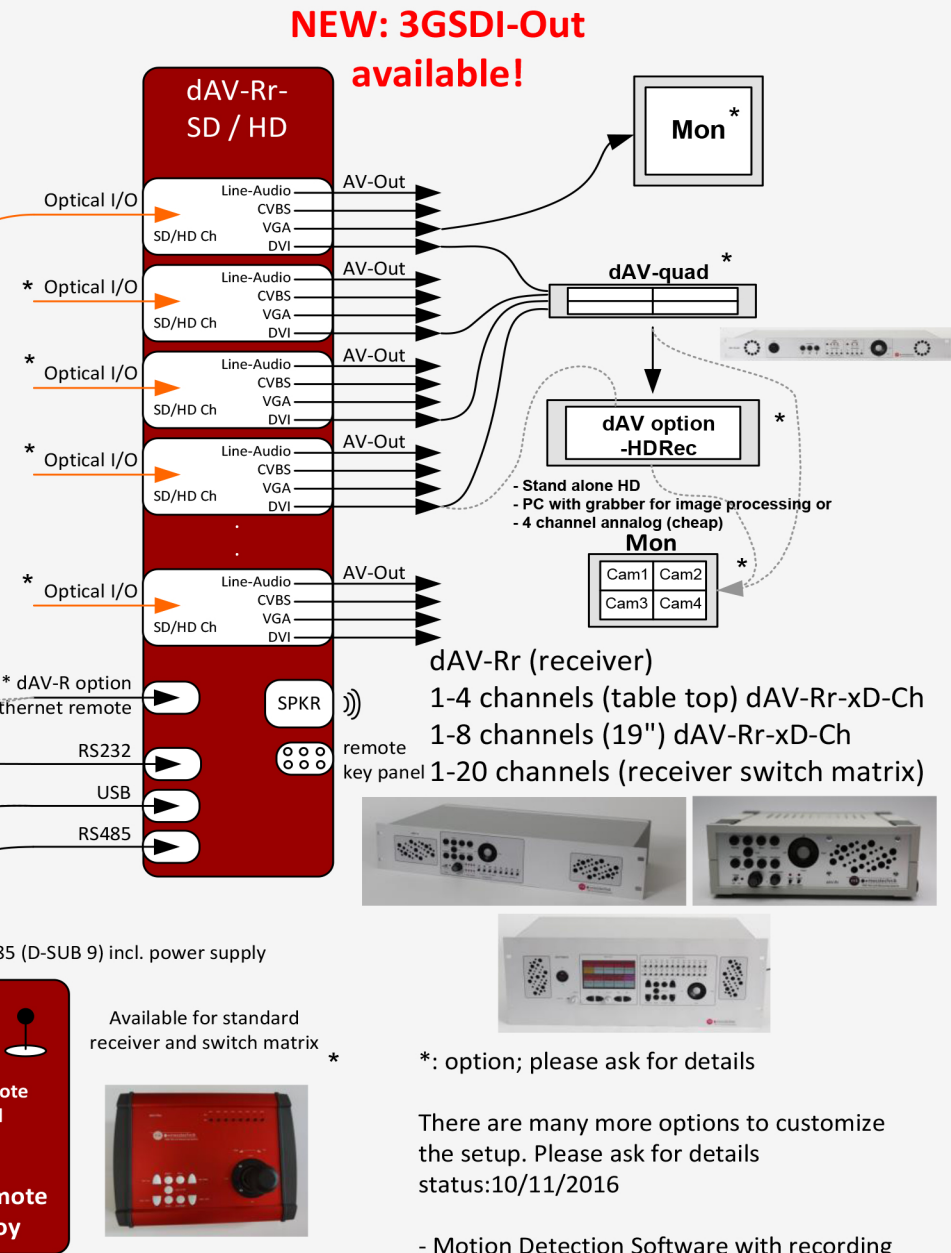

\*: option; please ask for details

There are many more options to customize the setup. Please ask for details  
status:10/11/2016

- Motion Detection Software with recording
- Water resistant camera and pan/tilt for OATS