

BM-02

Very Wide Band Omni-Directional Antenna

The BM-02 antenna is very wide band (25 to 1000 MHz), electrically small biconical monopole antenna designed for low frequency testing and wideband communications systems eliminating the need for large antennas or tuning systems.

The antenna is housed and sealed in a rugged radome to insure long life and electrical repeatability. A magnetic mount is provided with the antenna for use on metal surfaces. Contact a TMC Design sales representative for available mounting, mating and power options.



FEATURES

- Lightweight
- 360 degree coverage
- Durable construction
- Quick and easy to setup
- Durable fiberglass construction
- Includes magnetic base for mounting to metal surfaces
- The BM-02 is designed to operate under rigorous conditions and environments.
- All TMC Design antennas are designed and manufactured under with the auspices of our AS9100/ISO9000-certified quality management program

SPECIFICATIONS

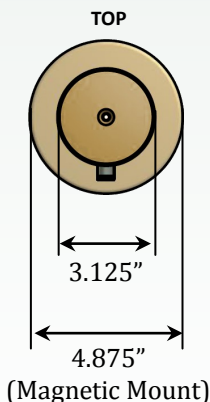
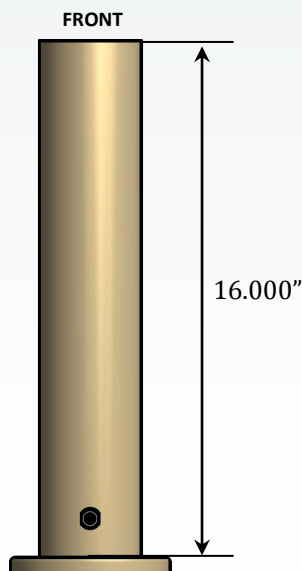

Type	Biconical Monopole
Frequency Range	25 to 1000 MHz
Gain	-2 dB avg.
Polarization	Linear (Vertical)
HPBW	360° x 85°
Maximum Power	100 Watts, CW
Maximum VSWR	3.5:1
Connector	Type-N, female
Height	16.000"
Diameter	3.125"
Weight	4 lbs
Temperature	-40° to 50° C



BICONICAL MONOPOLE



OMNI-DIRECTIONAL



25 TO 1000 MHz



LINEAR



TMC Design Corporation

BM-02

Very Wide Band Omni-Directional Antenna

CUSTOMIZE YOUR ANTENNA

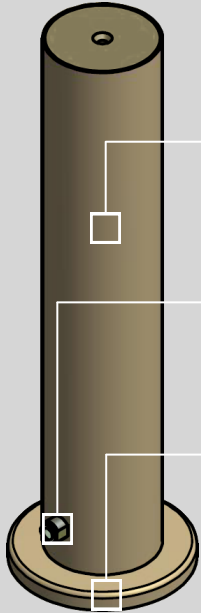

HIGH-POWER OPTIONS

To increase range and improve reception, most TMC Design antennas can be modified operate in high-power applications.

COLOR OPTIONS



A variety of paint options are available to fulfill your coating requirements. Federal Standard 595B colors, Chemical Agent Resistant Coating (CARC) or spot color schemes are available. Contact a TMC Design representative to specify coating options (*most popular colors shown above*).

RF MATING OPTIONS

All TMC Design antennas can be modified to include an RF connector that best fits your application. Be sure to specify the connector that is needed or ask one of our representatives for assistance in finding an RF mating solution that will best fit your requirements.

MOUNTING OPTIONS

Antennas can be modified to be mounted in the manner that best fits your requirements. Magnetic mounts are recommended for applications involving automobiles. A tripod will best fit situations where quick-setup and temporary emplacement necessary. Other options include antenna towers, and solar-powered mount systems for remote operation. Contact a TMC Design representative for assistance in choosing the best mounting option.

PERFORMANCE

Gain v Frequency (25 to 1000 MHz)

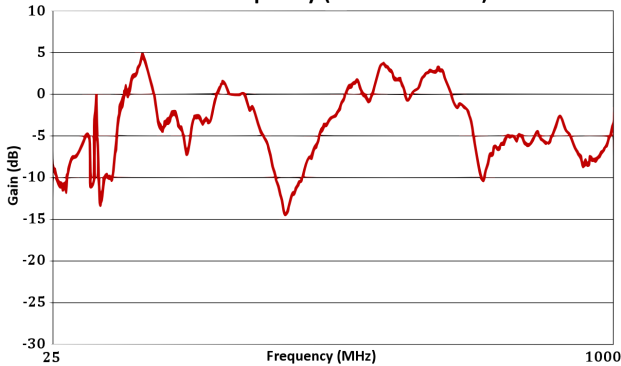

VSWR (25 to 1000 MHz)

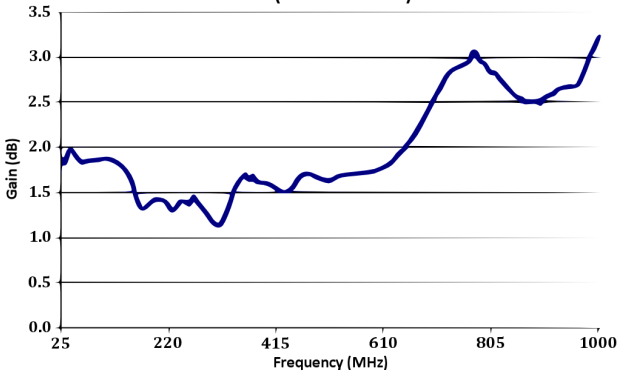

Antenna Pattern
Azimuth (940 MHz)

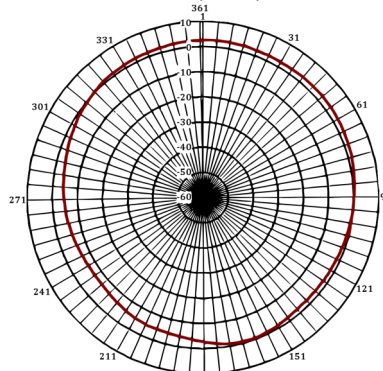

Antenna Pattern
Azimuth (231 MHz)

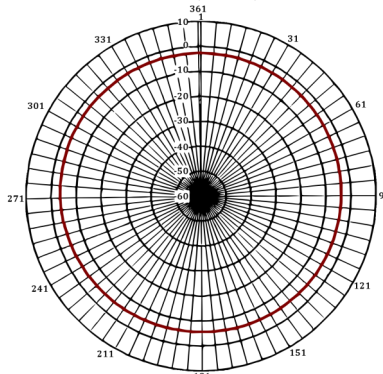

TMC Design Headquarters

4325 Del Rey Blvd.
Las Cruces, NM 88012
(tel) 575-382-4600
(fax) 575-523-8588

TMC Design Space Operations Center

7765 Electronic Drive
Colorado Springs, CO 80922
(tel) 719-622-0130
(fax) 719-622-0134

TMC Design Space Planning & Tactics

5030 Bradford Drive
Building 1, Suite 230
Huntsville, AL 35805
(tel) 256-830-4055
(fax) 256-830-4066

www.tmcdesign.com

tmc@tmcdesign.com



**AS9100B
KEMA CERTIFIED**

Accredited by
ANAB



**ISO9001:2008
KEMA CERTIFIED**

Accredited by
ANAB

March 2011, Rev.3